



AF64-4004 & AF64-4004BLK

Small Block Chevy low mount passenger side alternator bracket kit.

Congratulations on the purchase of your new AeroFlow Performance Product
We recommend applying Anti-Seize to all threads when assembling bracket.

1) Disconnect Battery; remove all existing accessory drive brackets and components from motor. Disconnect all existing power steering lines.

Thread cleaners are available at your local auto parts store or tool dealer and are different from a thread cutting tap.

3) Loosely assemble alternator bracket by inserting the (2) 3/8-16 x 77mm socket head cap screws through front bracket. Place 48mm spacer on top bolt. Place in order on bottom bolt 1-3/32" spacer, rose joint assembly then 8mm spacer. Thread completed assembly through rear bracket and into engine block. Do not tighten at this time

4) Attach small aluminum ear bracket to back of alternator mount boss with (1) 5/16-18 x 22mm socket head cap screw and tighten (26 ft./lb.)

5) Place alternator between front and rear brackets, thread (1) 3/8-16 x 22mm socket head cap screw through front bracket, alternator and into rear bracket. Finger tighten.

6) Swing Rose joint assembly up to aluminum ear bracket and thread (1) 3/8-16 x 25mm socket head cap screw through turnbuckle and into aluminum ear bracket and tighten (46 ft./lb.)

7) Tighten the (2) 3/8-16 x 77mm socket head cap screws into engine block at this time. (46 ft./lb.)

8) Route V-Belt over water pump pulley, crank pulley and alternator pulley. Turn rose joint adjuster until proper belt tension is achieved. Tighten jam nuts on rose joints Tighten alternator socket head cap screw at this time. (46 ft./lb.) Re-check belt tension.

9) Reconnect electrical and test run motor. Re-check belt tension after 100 km's.

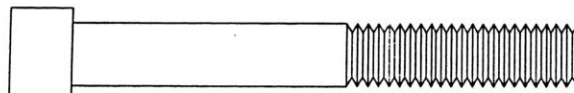
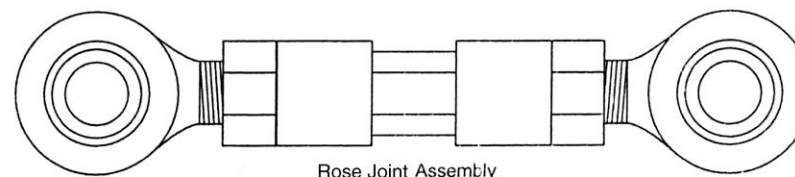
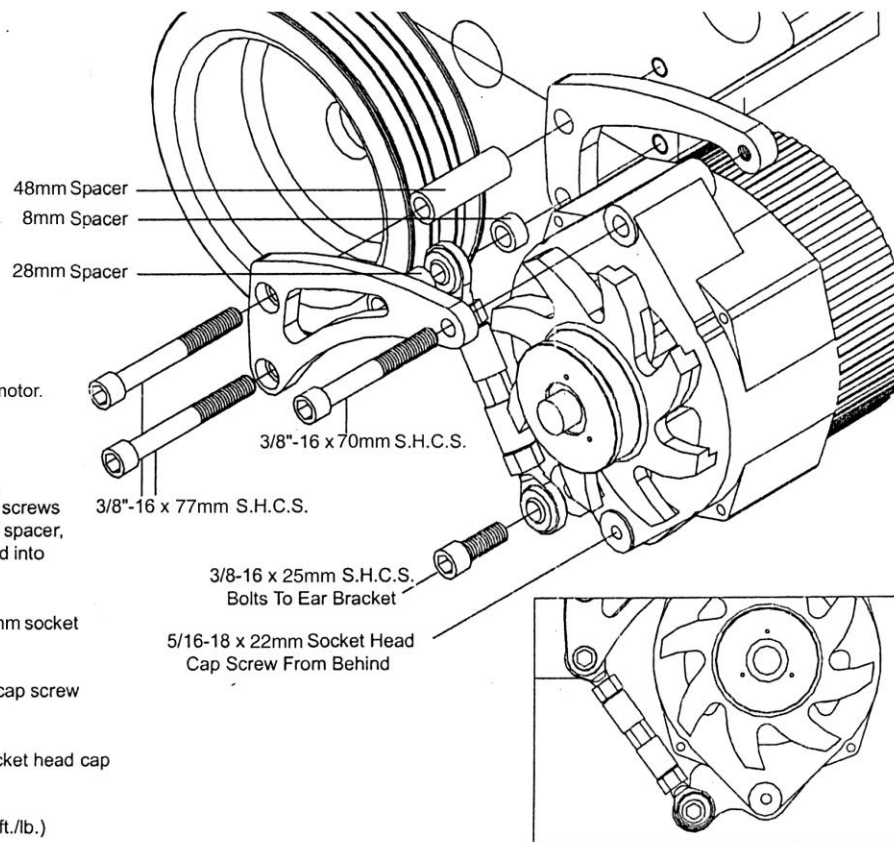

(2) 3/8-16 x 77mm Socket Head Cap Screw

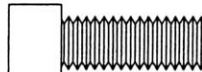

(1) 5/16-18 x 22mm Socket Head Cap Screw

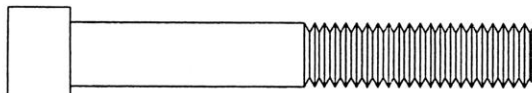

(1) 3/8-16 x 70mm Socket Head Cap Screw

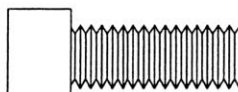

(1) 3/8-16 x 25mm Socket Head Cap Screw

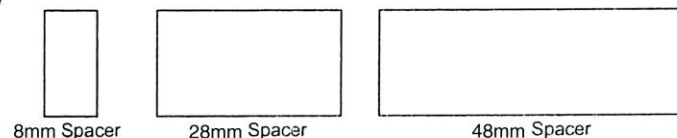

www.aeroflowperformance.com