

■ Installation Diagram

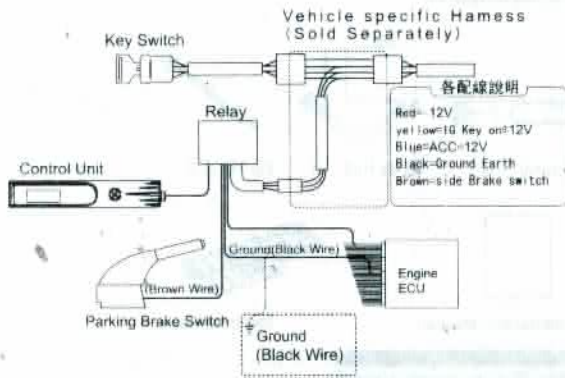

■ How to use the Electrotaps (Parking Brake Switch)

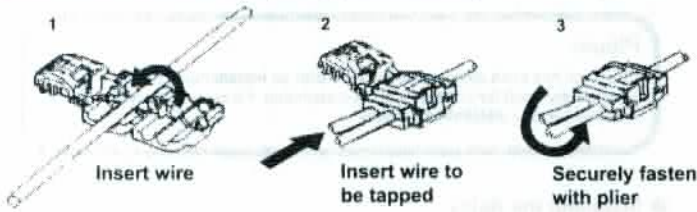

■ How to Splice the wires

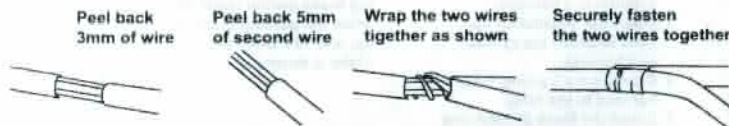

■ Be sure to cover the wires with electrical tape.

■ Checking the Safety Switch (Parking Brake Switch)

1. Pull the parking brake, start the engine, and make sure the IG key is ON.
2. Set the Timer to a random setting above 30 seconds.
3. Turn the IG key OFF to activate the Timer countdown.
4. Release the parking brake during the countdown process.
5. Be sure the engine shuts completely off.

50peration

■ Part Names and Functions

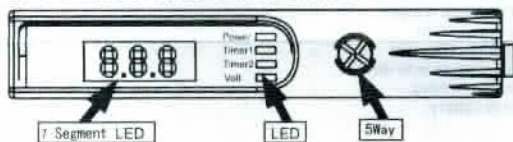

Glossary of items:
(Hold) Tilt knob over 0.5 sec in specified direction.

■ Display

Tuning the IG key ON will activate the display mode.
(Power must be on)
Contents may be checked through flashing lights.

Display Parameters

- Power
- Timer1
- Timer2
- Volt

■ Choose Display Parameter

TO toggle between Timer1→Timer2→Volt Idling Time.

[Activate the knob either Up or DOWN]

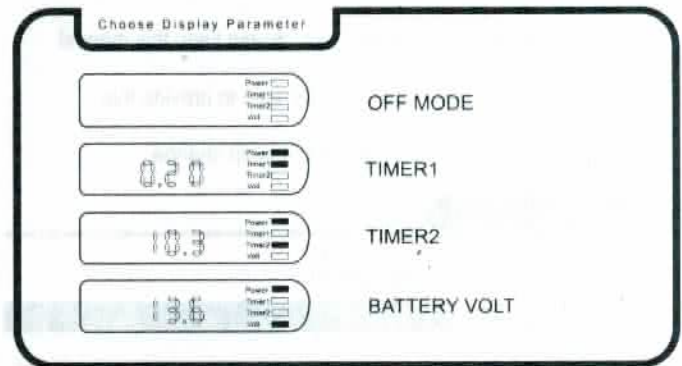

■ Setting the Minimum Battery Voltage Warning



● To activate Setting Mode.....

While battery voltage is being displayed
will flash indicating that the setting mode has been activated

● After setting.....

This will return to the Display Mode

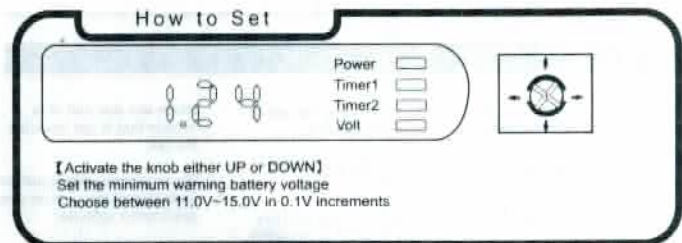

■ Setting the After Idling Time

● To activate Setting Mode...

While After Idling is being displayed.



(Hold the knob)

TIME will flash indicating that the setting mode has been activated.

● After setting...

(Hold the knob to the LEFT)



This will return to the Display Mode

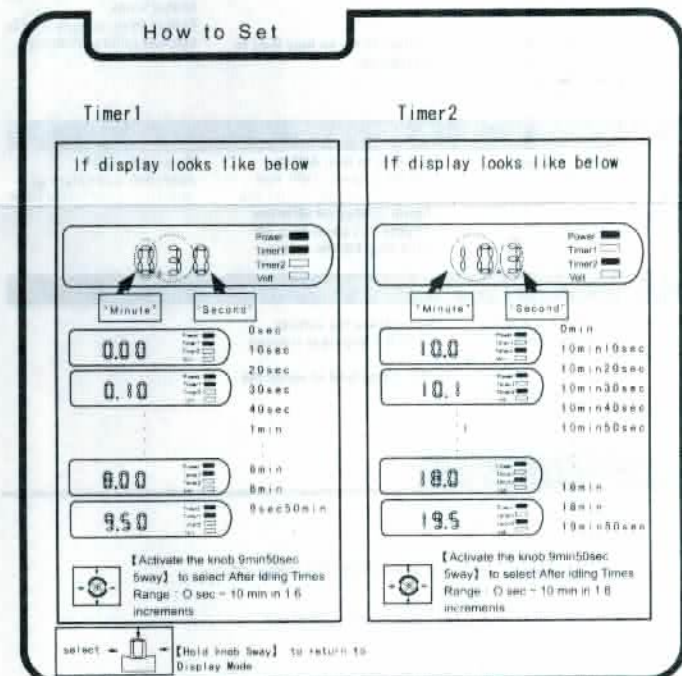



Thank you for purchasing this product. Please read all of this manual to ensure proper usage. Also, please keep this manual in a safe place for future reference. Be sure to provide this manual to the next user in case of ownership change.

1 Safety Precautions

GLOSSARY

For safe use of this products be sure to read the safety Precautions. Keep the manual in a safe place after use for future reference. We have included these warnings to protect the user and dealer from unnecessary harm. These points have been marked throughout this manual by SIGNAL WORDS. Please refer to the table on the left for a glossary of term meanings.

Display	Meanings
 WARNING	Failure to do so may result in death or severe injury to the user and others.
 CAUTION	Failure to do so may result in light injury to the user and others or product and engine damage.
 PLEASE	Failure to do so may result in product malfunction and damage.

CAUTION

Be sure to secure this unit in a safe location away from the driver. Failure to do so may lead to accidents.

Always connect the hand brake wire.

Failure to do so may lead to accidents.

Do not expose the unit to excessive shock.

This could lead to unit malfunction.

Be sure that the unit has been properly connected when selling the vehicle. Also, be sure to the new user.

Never use this unit on a vehicle that is not intended for use.

We cannot guarantee proper operation of this unit on non application vehicles.

WARNING

This product should ONLY be installed by a professional installer.

Installation requires past experience to prevent damage to the unit and vehicle.

Do not use this product for any other purpose than the one listed in this manual.

We are not responsible for any damages or injuries incurred from improper usage of this product.

Discontinue use of this product immediately if any unusual odor or smoke comes from the unit. Failure to do so may result in electrical shorts and potential engine fire.

Never operate this unit while driving.

Failure to do so may lead to accidents.

Never disassemble or tamper with this unit.

This could lead to serious injury.

Do not leave the engine running in closed garages or sealed areas. Failure to do so may lead to exhaust fume poisoning.

CONSIDER

Remote Door Lock Systems and Adjustable Steering. Properly after installation of this unit.

Be sure to turn AUTO LIGHT systems OFF. Failure to do so may cause the lights to stay on after the engine has been shut off. This may kill the battery.

Be sure to unit operation and safety wire operation after installation.

WARNING

Be sure to shut off the engine when sleeping inside the vehicle.

Failure to do so may result in exhaust poisoning.

Never leave the vehicle while the engine is running.

This could lead to accidents.

2 Product Features

This unit will work on any 12V vehicle.

Displays battery voltage. Also WARS of extremely LOW battery voltages.

119way adjustment of Count down timing from 0-19min50sec

Parking Brake safety switch

3 Parts List

- Be sure to check the contents before attempting installation.
- Please notify your dealer of purchase for any missing or broken parts BEFORE attempting installation.



Control Unit



Relay Unit --- 1



Zip Tie --- 2



Double Sides Tape --- 1



Instruction Manual



Electro - Tap --- 1

4 Installation Procedures

Relay and Control Unit Installation

Please

This unit has been designed to be used with an installation harness (separately sold) for ultimate ease in installation. Please purchase a vehicle specific installation harness.

● Installing the Relay

1. Disconnect the negative terminal of the battery.
2. Pull the harness coming from the key cylinder. (In some vehicles, the whole key cylinder is a harness).
3. Insert the installation harness between the cylinder and harness.
4. Connect the 3 prong Timer harness to the relay.
5. Splice the black ground wire from the relay into the Engine ECU ground wire.
6. Splice the brown parking brake wire from the relay to the parking brake switch. (With the IG key ON, be sure to check that the parking brake switch reads 0V when the parking brake is up, and 12V when the brake is down.)



CAUTION

Do not mount the unit near high temperatures, dust, or under direct sunlight.

When mounting with double sided tape, take care not to damage the case when relocating.

Please

Be sure to remove all oil and debris from unit before mounting.

Never pull hard on any connectors or harnesses.

● Mounting the Control Unit

1. Use the included double sided tape to mount.
2. Mount in a location that does not interfere with driving. Connect to relay.
3. Reconnect battery.

注意事項：

安裝時不可將Turbo Timer本體端的連接器線路剪斷，
一旦如此本公司將不提供產品保固。

IMPORTANT :

Please do not disconnect the wiring connection in
the connector. The warranty shall not apply if the
wires are being cut.

